

DRAWINGS

File: G:\Projects\2017\12\12 - Vaughan VMC Black Creek Renewal Class EA - Drawings\Fig 6 ESR Preliminary Design & Shading\1212-CH1-CP06.dwg, Layout: CH1, Date: Jul 19, 2018 - 1:25pm, Ed: By: jpathmanagan

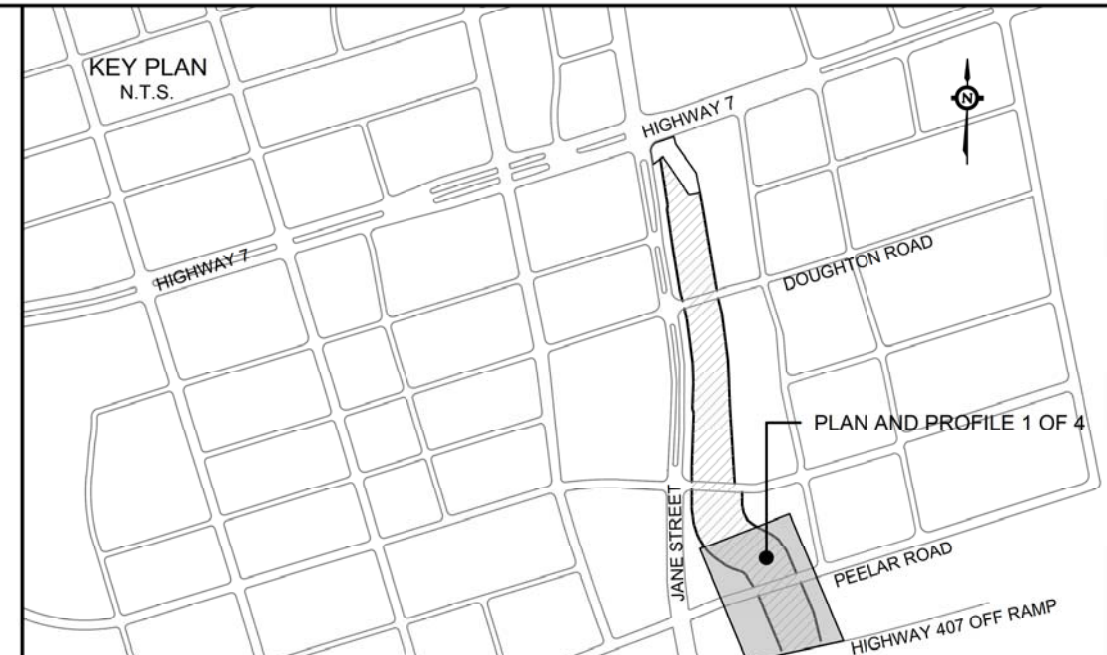
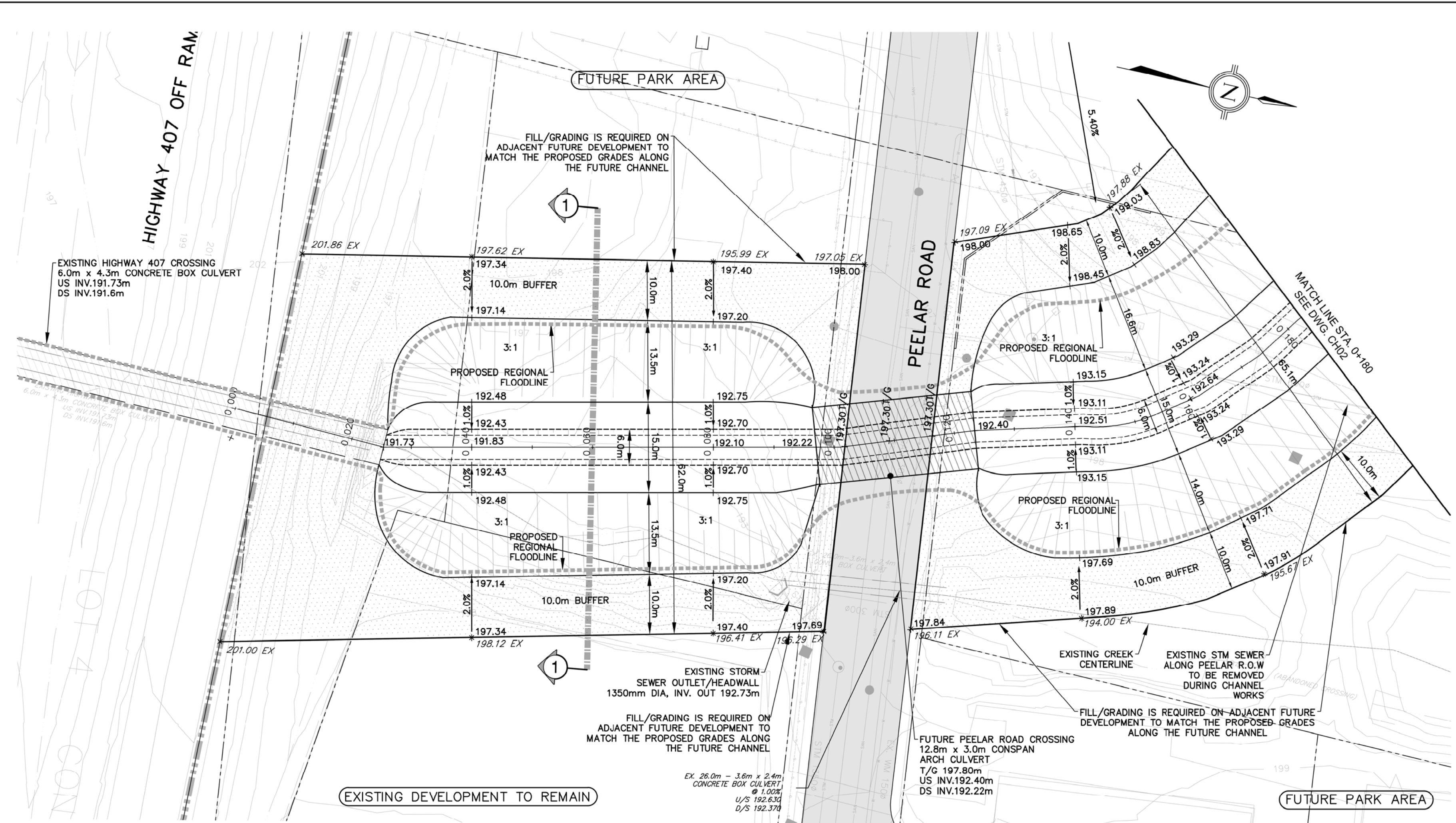

CONTRACTOR'S NOTES:
 1. ALL DIMENSIONS ARE IN METRES UNLESS OTHERWISE INDICATED.
 2. DRAWINGS ARE NOT TO BE SCALED FOR CONSTRUCTION.
 3. THE CONTRACTOR SHALL VERIFY ALL DIMENSIONS IN THE FIELD AND SHALL REPORT ANY DISCREPANCIES TO THE ENGINEER IMMEDIATELY UPON THEIR DISCOVERY.
 4. THE EXACT LOCATION OF UTILITIES SHALL BE DETERMINED BY CONSULTING THE UTILITY COMPANIES CONCERNED. THE CONTRACTOR SHALL PROTECT THE LOCATION OF UTILITIES AND SHALL BE RESPONSIBLE FOR ADEQUATE PROTECTION FROM DAMAGE.
 5. BENCHMARKS FOR LAYOUT ARE TO BE OBTAINED FROM THE CITY OF VAUGHAN ENGINEERING DEPARTMENT.

NOTE:
 EVERY REASONABLE EFFORT HAS BEEN MADE TO ENSURE THAT THE INFORMATION APPEARING ON THIS PLAN IS ACCURATE AND CURRENT. WE BELIEVE THE INFORMATION TO BE RELIABLE, HOWEVER, THE CITY OF VAUGHAN ASSUMES NO RESPONSIBILITY OR LIABILITY DUE TO ERRORS OR OMISSIONS.

BENCH MARK:
 (Symbol for benchmark)

ELEVATION:
 (Symbol for elevation)

LEGEND

| | |
|----------|-------------------------------|
| (Symbol) | STUDY AREA BOUNDARY |
| (Symbol) | EXISTING CREEK |
| (Symbol) | PROPOSED ELEVATION |
| (Symbol) | EXISTING ELEVATION |
| (Symbol) | PROPOSED REGIONAL FLOODLINE |
| (Symbol) | PROPERTY LIMIT |
| (Symbol) | EXISTING STREET LIGHT / POLES |
| (Symbol) | EXISTING WATERMAIN |
| (Symbol) | EXISTING WATER VALVES |
| (Symbol) | EXISTING HYDRANTS |
| (Symbol) | EXISTING CATCHBASIN |
| (Symbol) | EXISTING STM MANHOLE |
| (Symbol) | EXISTING STM PIPES |
| (Symbol) | EXISTING SAN PIPES |
| (Symbol) | EXISTING SAN MANHOLE |
| (Symbol) | EXISTING GAS PIPES |

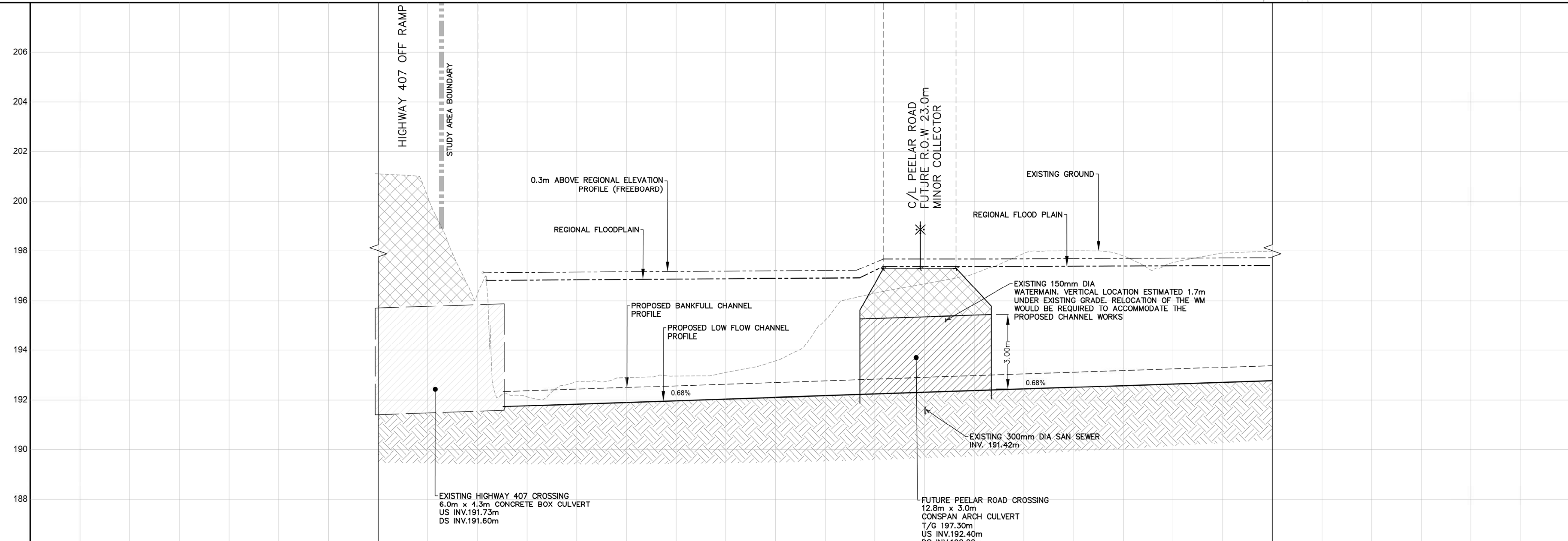

| | | | |
|-----|--------------------|-----------|----------|
| 7 | | | |
| 6 | | | |
| 5 | | | |
| 4 | | | |
| 3 | | | |
| 2 | | | |
| 1 | PRELIMINARY DESIGN | T.D./E.T. | OCT 2017 |
| NO. | DESCRIPTION | BY | DATE |

TMIG
 The Municipal Infrastructure Group Ltd
 5800 Dufferin Street, Suite 200, Vaughan, ON L4K 0C5
 p: 905.738.5700, f: 905.738.0065

ENGINEER'S STAMP:
 APPROVED AS TO FORM IN RELIANCE UPON THE PROFESSIONAL SKILL AND ABILITY OF THE CONSULTING ENGINEERS AS TO DESIGN AND SPECIFICATIONS.
 JACK GRAZIOSI, P.Eng., M.Eng., DIRECTOR OF ENGINEERING SERVICES
 DATE

VAUGHAN VMC BLACK CREEK RENEWAL CLASS EA
 PRELIMINARY CHANNEL DESIGN
 PLAN AND PROFILE 1 OF 4

VAUGHAN
 Engineering Services

| | | |
|---|-------------------|-------------------|
| DESIGNED BY: T.D. | DATE: AUGUST 2018 | CHECKED BY: E.T. |
| DRAWN BY: M.M. | SURVEYED BY: | APPROVED BY: S.H. |
| SCALE: HORIZONTAL: 1:500, VERTICAL: 1:100 | PROJ. No. 12122 | DWG. No. 1 of 7 |

| | | | | | | | | | | | | | | | | |
|---------------------|--|-----------|-----------|--------|--------|--------|-----------|--------|--------|--------|-----------|--------|--------|--------|-----------|--|
| LOW FLOW ELEVATION | | 201.86 EX | 197.62 EX | 197.34 | 197.40 | 197.20 | 197.09 EX | 198.00 | 197.84 | 197.89 | 194.00 EX | 197.89 | 197.71 | 197.91 | 195.67 EX | |
| CENTERLINE CHAINAGE | | 0+000 | 0+020 | 0+040 | 0+060 | 0+080 | 0+100 | 0+120 | 0+140 | 0+160 | 0+180 | 0+200 | 0+220 | 0+240 | 0+260 | |

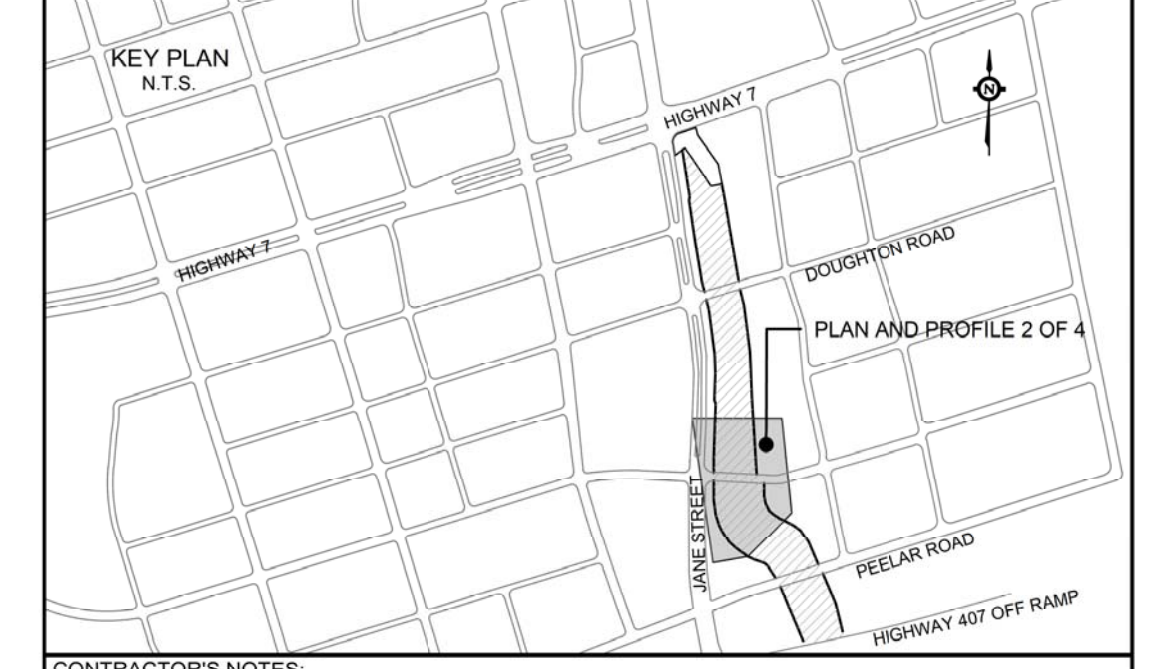
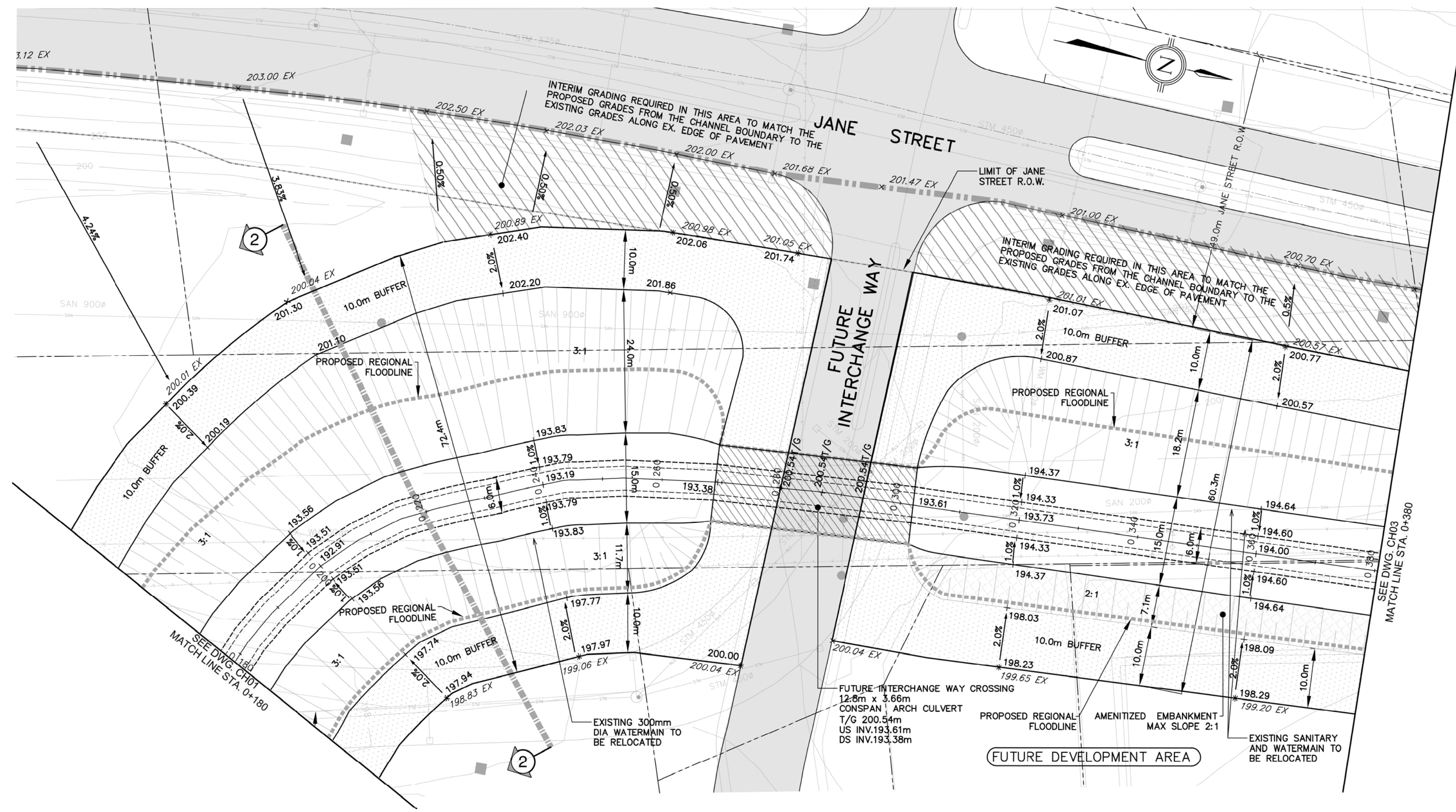

CONTRACTOR'S NOTES:
 1. ALL DIMENSIONS ARE IN METRES UNLESS OTHERWISE INDICATED.
 2. DRAWINGS ARE NOT TO BE SCALED FOR CONSTRUCTION.
 3. THE CONTRACTOR SHALL VERIFY ALL DIMENSIONS IN THE FIELD AND SHALL REPORT ANY DISCREPANCIES TO THE ENGINEER IMMEDIATELY UPON DISCOVERY.
 4. THE EXACT LOCATION OF UTILITIES SHALL BE DETERMINED BY CONSULTING THE UTILITY COMPANIES CONCERNED. THE CONTRACTOR SHALL PROTECT THE LOCATION OF UTILITIES AND SHALL BE RESPONSIBLE FOR ADEQUATE PROTECTION FROM DAMAGE.
 5. BENCHMARKS FOR LAYOUT ARE TO BE OBTAINED FROM THE CITY OF VAUGHAN ENGINEERING DEPARTMENT.

NOTE:
 EVERY REASONABLE EFFORT HAS BEEN MADE TO ENSURE THAT THE INFORMATION APPEARING ON THIS PLAN IS ACCURATE AND CURRENT. WE BELIEVE THE INFORMATION TO BE RELIABLE, HOWEVER, THE CITY OF VAUGHAN ASSUMES NO RESPONSIBILITY OR LIABILITY DUE TO ERRORS OR OMISSIONS.

BENCH MARK:
 ELEVATION:

LEGEND

| | |
|--|-------------------------------|
| | STUDY AREA BOUNDARY |
| | EXISTING CREEK |
| | PROPOSED ELEVATION |
| | EXISTING ELEVATION |
| | PROPOSED REGIONAL FLOODLINE |
| | PROPERTY LIMIT |
| | EXISTING STREET LIGHT / POLES |
| | EXISTING WATERMAIN |
| | EXISTING WATER VALVES |
| | EXISTING HYDRANTS |
| | EXISTING CATCHBASIN |
| | EXISTING STM MANHOLE |
| | EXISTING STM PIPES |
| | EXISTING SAN PIPES |
| | EXISTING SAN MANHOLE |
| | EXISTING GAS PIPES |

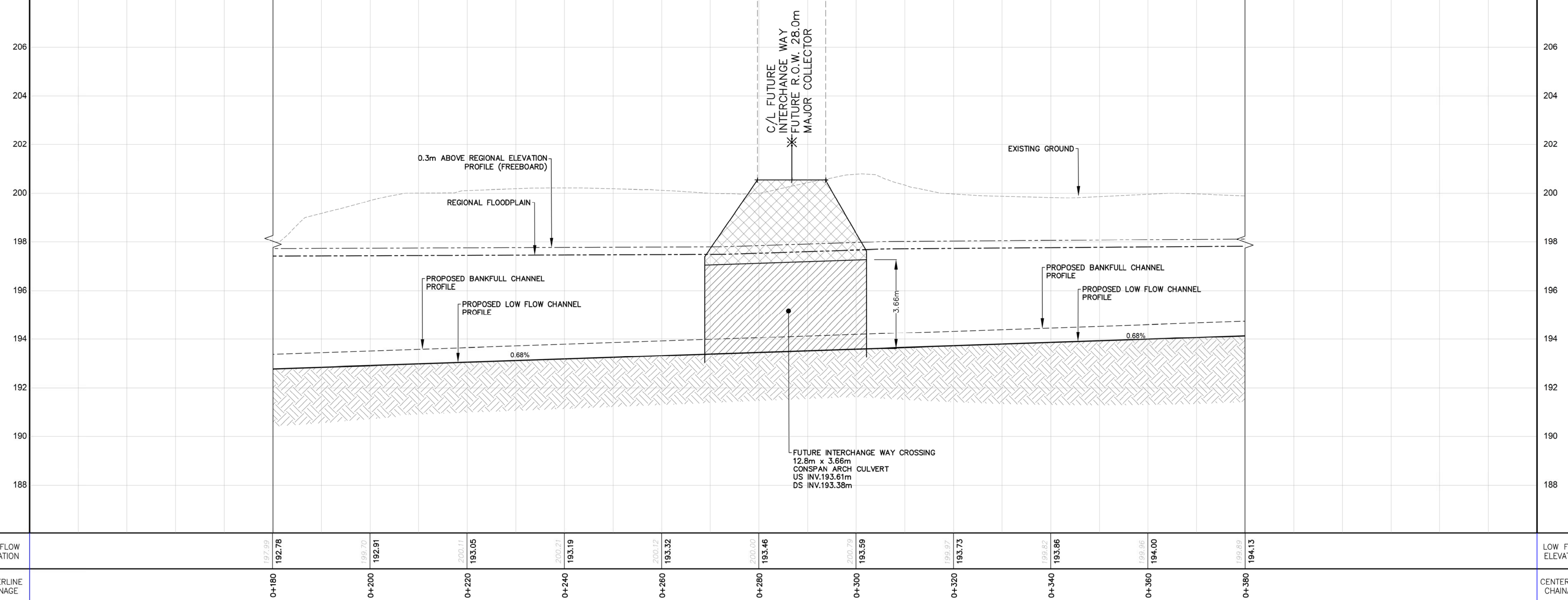

| | | | |
|-----|--------------------|-----------|----------|
| 7 | | | |
| 6 | | | |
| 5 | | | |
| 4 | | | |
| 3 | | | |
| 2 | | | |
| 1 | PRELIMINARY DESIGN | T.D./E.T. | OCT 2017 |
| NO. | DESCRIPTION | BY | DATE |

UPDATES & REVISIONS

TMIG
The Municipal Infrastructure Group Ltd

5800 Dufferin Street,
Suite 200
Vaughan, ON
L4K 0C5
p: 905.738.5700
f: 905.738.0065

ENGINEER'S STAMP:

APPROVED AS TO FORM IN RELIANCE UPON THE PROFESSIONAL SKILL AND ABILITY OF THE CONSULTING ENGINEERS AS TO DESIGN AND SPECIFICATIONS.

JACK GRAZIOSI, P.Eng., M.Eng.
DIRECTOR OF ENGINEERING SERVICES

DATE

VAUGHAN VMC BLACK CREEK RENEWAL CLASS EA
 PRELIMINARY CHANNEL DESIGN
 PLAN AND PROFILE 2 OF 4

VAUGHAN
Engineering Services

| | | |
|--|--------------------|--------------------|
| DESIGNED BY: T.D. | DATE: AUGUST 2018 | CHECKED BY: E.T. |
| DRAWN BY: M.M. | SURVEYED BY: | APPROVED BY: S.H. |
| SCALE: HORIZONTAL: 1:500 VERTICAL: 1:100 | PROJ. No. 12122 | DWG. No. 2 of 7 |

File: G:\Projects\08121212 - Vaughan VMC Black Creek Renewal Class EA - Drawings\Fig 2 ESR Preliminary Design & Shading\Fig 2 ESR Preliminary Design & Shading.dwg, Layout: CH02, Date: Jul 19, 2018 - 1:32pm, Edit By: jpathmanagan

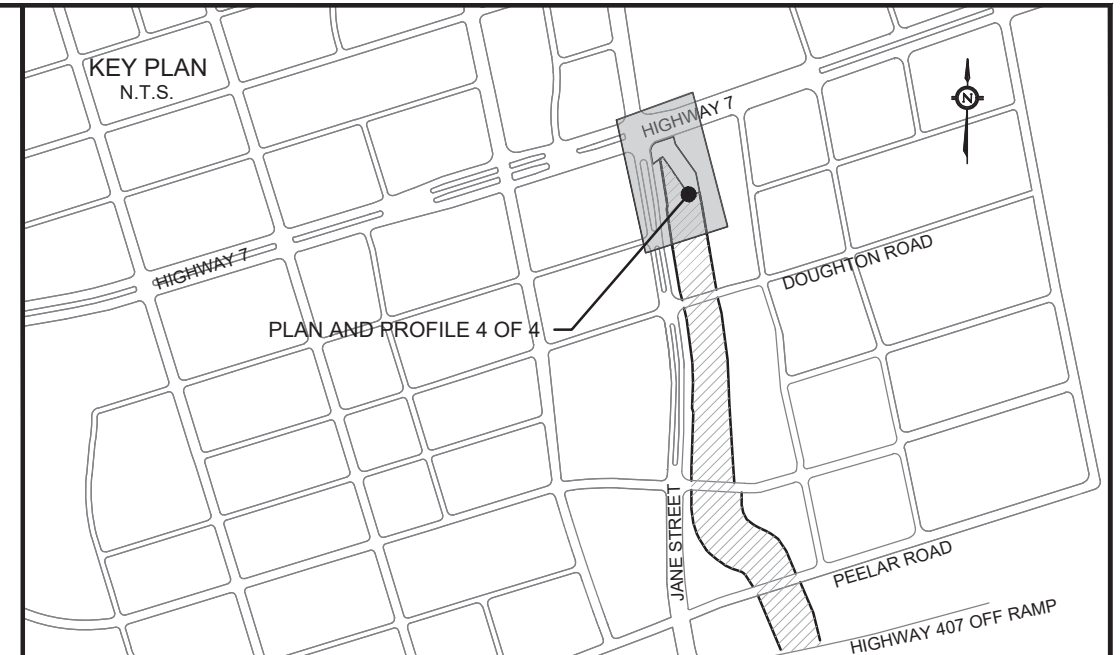
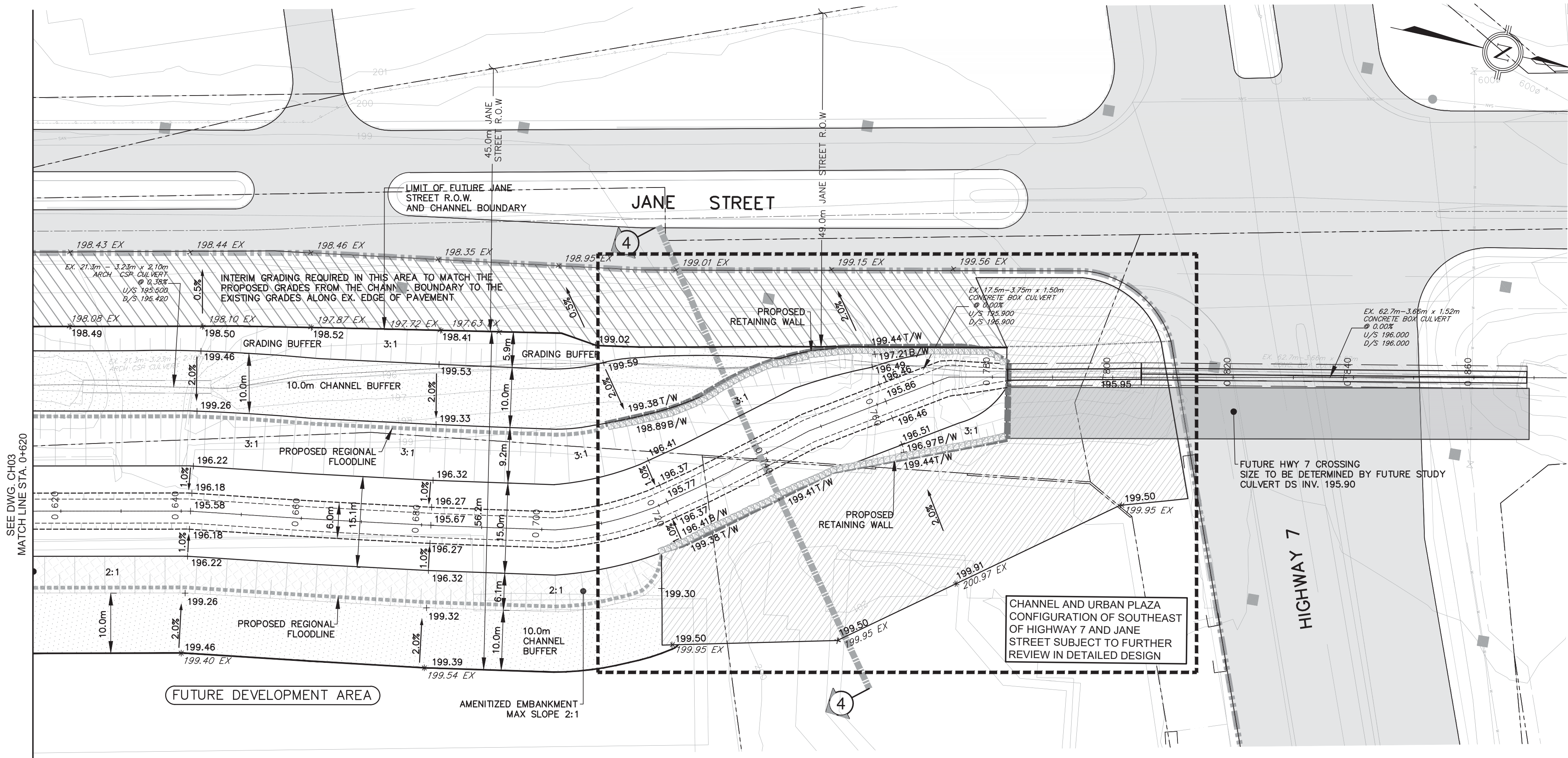

CONTRACTOR'S NOTES:
 1. ALL DIMENSIONS ARE IN METRES UNLESS OTHERWISE INDICATED.
 2. DRAWINGS ARE TO BE SCALED FOR CONSTRUCTION.
 3. THE CONTRACTOR SHALL VERIFY ALL DIMENSIONS IN THE FIELD AND SHALL REPORT ANY DISCREPANCIES TO THE ENGINEER IMMEDIATELY UPON DISCOVERY.
 4. THE EXACT LOCATION OF UTILITIES SHALL BE DETERMINED BY CONSULTING THE UTILITY COMPANIES CONCERNED. THE CONTRACTOR SHALL PROTECT THE LOCATION OF UTILITIES AND SHALL BE RESPONSIBLE FOR ADEQUATE PROTECTION FROM DAMAGE.
 5. BENCHMARKS FOR LAYOUT ARE TO BE OBTAINED FROM THE CITY OF VAUGHAN ENGINEERING DEPARTMENT.

NOTE:
 EVERY REASONABLE EFFORT HAS BEEN MADE TO ENSURE THAT THE INFORMATION APPEARING ON THIS PLAN IS ACCURATE AND CURRENT. WE BELIEVE THE INFORMATION TO BE RELIABLE, HOWEVER, THE CITY OF VAUGHAN ASSUMES NO RESPONSIBILITY OR LIABILITY DUE TO ERRORS OR OMISSIONS.

BENCHMARK:
 BENCHMARK LOCATED: _____

ELEVATION:

LEGEND

| | |
|-------|-------------------------------|
| --- | STUDY AREA BOUNDARY |
| --- | EXISTING CREEK |
| + | PROPOSED ELEVATION |
| x | EXISTING ELEVATION |
| ----- | PROPOSED REGIONAL FLOODLINE |
| --- | PROPERTY LIMIT |
| ■ | EXISTING STREET LIGHT / POLES |
| — — | EXISTING WATERMAIN |
| — — | EXISTING WATER VALVES |
| ◇ | EXISTING HYDRANTS |
| □ | EXISTING CATCHBASIN |
| ○ | EXISTING STM MANHOLE |
| — — | EXISTING STM PIPES |
| — — | EXISTING SAN PIPES |
| ● | EXISTING SAN MANHOLE |
| — — | EXISTING GAS PIPES |

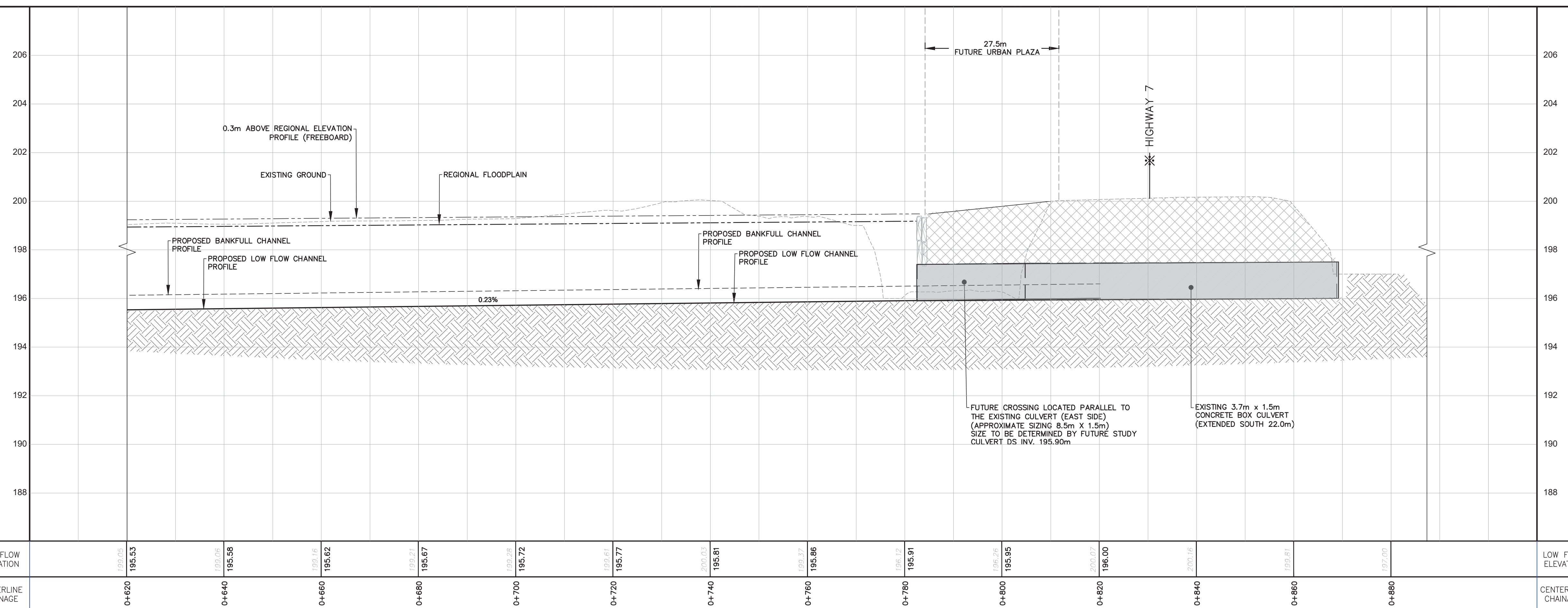

| | | | |
|-----|--------------------|-----------|----------|
| 7 | | | |
| 6 | | | |
| 5 | | | |
| 4 | | | |
| 3 | | | |
| 2 | | | |
| 1 | PRELIMINARY DESIGN | T.D./E.T. | OCT 2017 |
| NO. | DESCRIPTION | BY | DATE |

TMIG
 The Municipal Infrastructure Group Ltd

8800 Dufferin Street,
 Suite 200
 Vaughan, ON
 L4K 0C5
 p: 905.738.5700
 f: 905.738.0065

ENGINEER'S STAMP:

APPROVED AS TO FORM IN RELIANCE UPON THE PROFESSIONAL SKILL AND ABILITY OF THE CONSULTING ENGINEERS AS TO DESIGN AND SPECIFICATIONS.

JACK GRAZIOSI, P.Eng., M.Eng.
 DIRECTOR OF ENGINEERING SERVICES

DATE: _____

VAUGHAN VMC BLACK CREEK RENEWAL CLASS EA
 PRELIMINARY CHANNEL DESIGN
 PLAN AND PROFILE 4 OF 4

VAUGHAN
 Engineering Services

| | | |
|-------------------|-------------------|-------------------|
| DESIGNED BY: T.D. | DATE: AUGUST 2018 | CHECKED BY: E.T. |
| DRAWN BY: M.M. | SURVEYED BY: | APPROVED BY: S.H. |
| SCALE: | PROJ. No. | DWG. No. |
| HORIZONTAL: 1:500 | 12122 | 4 of 7 |
| VERTICAL: 1:100 | | |

File: G:\Projects\2017\1212 - Vaughan VMC Black Creek Renewal Class EA - Drawings\For ESR\Preliminary Design & Shaping\1212-CH04-CH04.dwg, Layer: CH04, Date: Jul 24, 2018 - 11:30am, Edit By: jpatmanagan

CROSS SECTION 1
SCALE HOR 1:250 VER 1:50

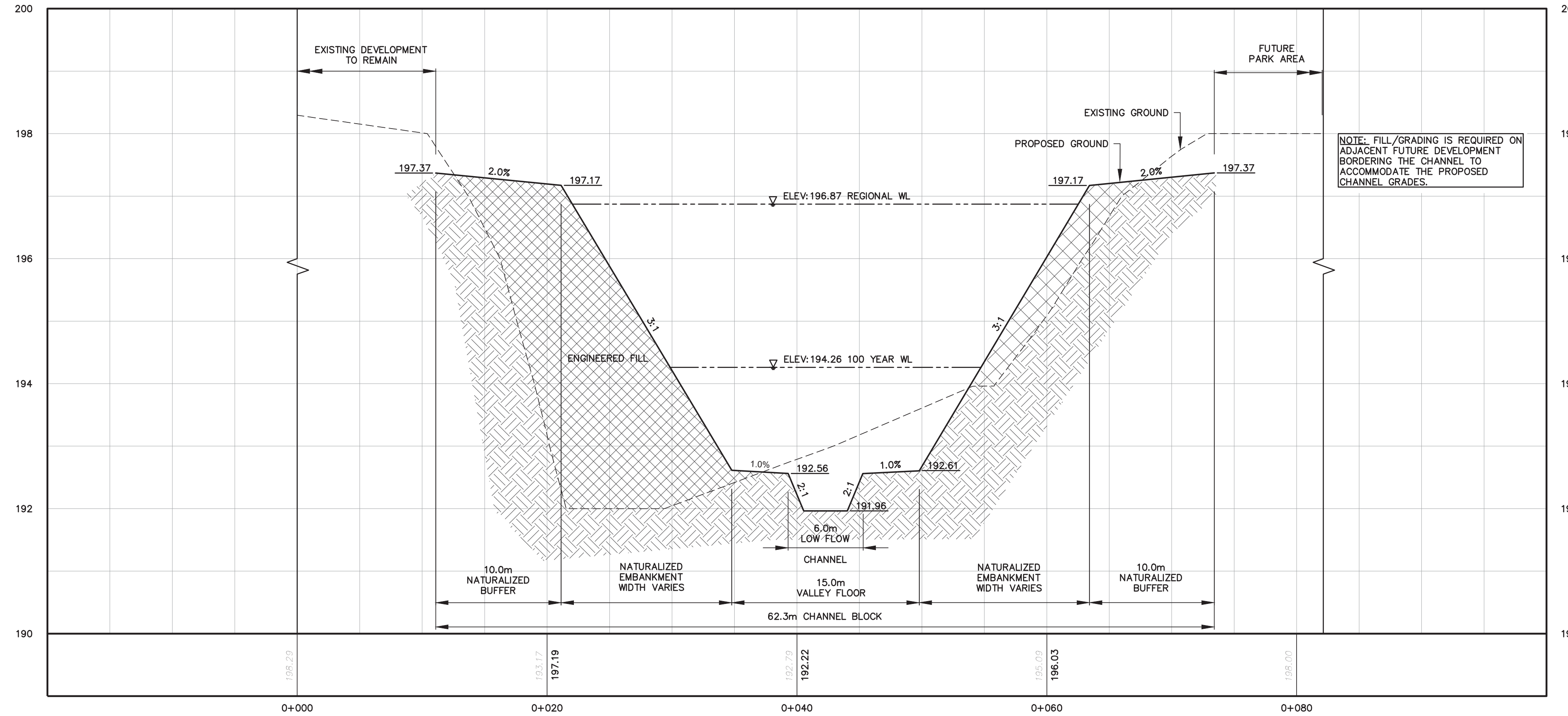

CROSS SECTION 2
SCALE HOR 1:250 VER 1:50

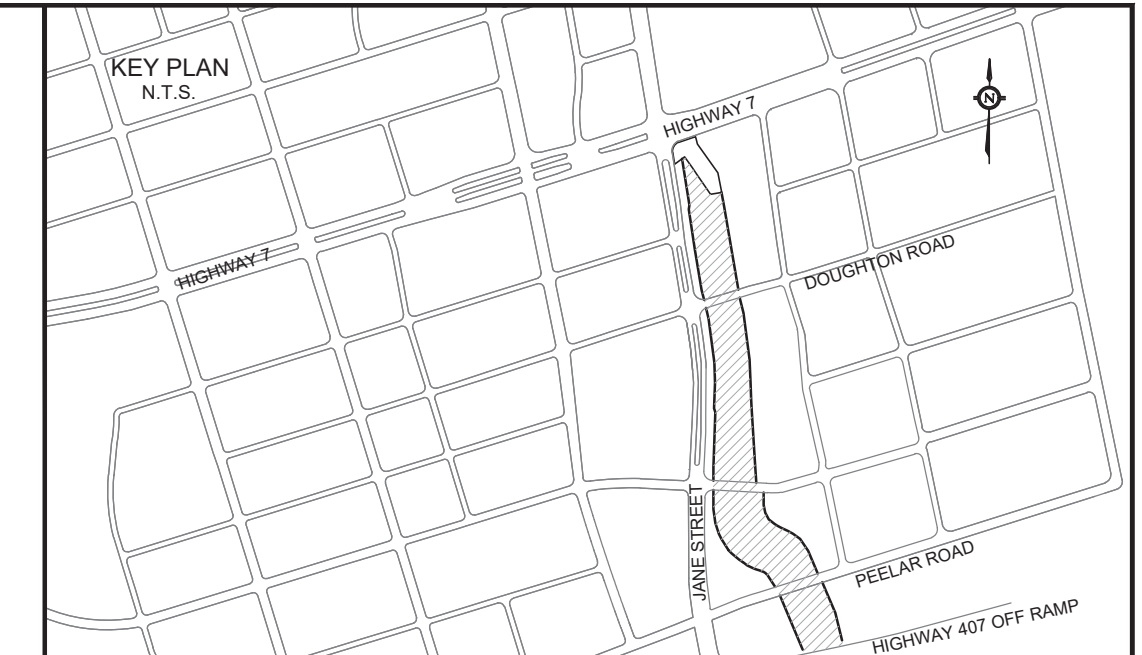
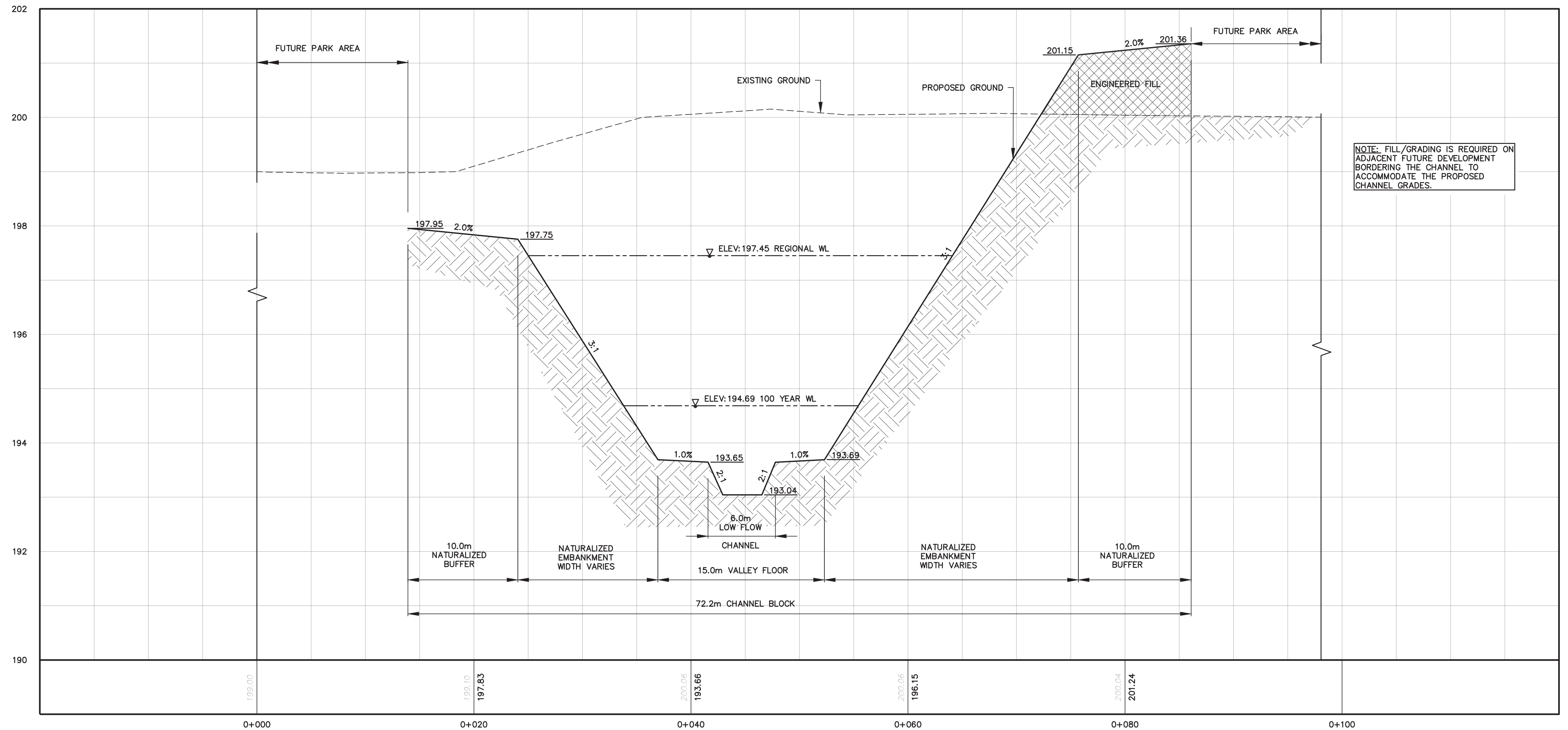

- CONTRACTOR'S NOTES:
1. ALL DIMENSIONS ARE IN METRES UNLESS OTHERWISE INDICATED.
 2. DRAWINGS ARE NOT TO BE SCALED FOR CONSTRUCTION.
 3. THE CONTRACTOR SHALL VERIFY ALL DIMENSIONS IN THE FIELD AND SHALL REPORT ANY DISCREPANCIES TO THE ENGINEER IMMEDIATELY UPON THEORE.
 4. THE EXACT LOCATION OF UTILITIES SHALL BE DETERMINED BY CONSULTING THE UTILITY COMPANIES CONCERNED. THE CONTRACTOR SHALL MARK THE LOCATION OF UTILITIES AND SHALL BE RESPONSIBLE FOR ADEQUATE PROTECTION FROM DAMAGE.
 5. BENCHMARKS FOR LAYOUT ARE TO BE OBTAINED FROM THE CITY OF VAUGHAN ENGINEERING DEPARTMENT.

NOTE:
EVERY REASONABLE EFFORT HAS BEEN MADE TO ENSURE THAT THE INFORMATION APPEARING ON THIS PLAN IS ACCURATE AND CURRENT. WE BELIEVE THE INFORMATION TO BE RELIABLE, HOWEVER, THE CITY OF VAUGHAN ASSUMES NO RESPONSIBILITY OF LIABILITY DUE TO ERRORS OR OMISSIONS.

BENCH MARK:
BENCHMARKS LOCATED:

ELEVATION:

LEGEND

NOTE: FOR CROSS SECTION LOCATION REFER TO CHANNEL DRAWINGS 1 TO 4

| | | | |
|-----|--------------------|---------|------|
| 7 | | | |
| 6 | | | |
| 5 | | | |
| 4 | | | |
| 3 | | | |
| 2 | | | |
| 1 | PRELIMINARY DESIGN | T.D/E.T | |
| NO. | DESCRIPTION | BY | DATE |

TMIG
The Municipal Infrastructure Group Ltd

8800 Dufferin Street,
Suite 200
Vaughan, ON
L4K 0C5
p: 905.738.5700
f: 905.738.0065

ENGINEER'S STAMP:

APPROVED AS TO FORM IN RELIANCE UPON THE PROFESSIONAL SKILL AND ABILITY OF THE CONSULTING ENGINEERS AS TO DESIGN AND SPECIFICATIONS.

JACK GRAZIOSI, P.Eng., M.Eng.
DIRECTOR OF ENGINEERING SERVICES

DATE

VAUGHAN VMC BLACK CREEK
RENEWAL CLASS EA
PRELIMINARY CHANNEL DESIGN
TYPICAL SECTIONS 1 OF 2



| | | |
|-------------------|-------------------|-------------------|
| DESIGNED BY: T.D | DATE: AUGUST 2018 | CHECKED BY: E.T. |
| DRAWN BY: M.M. | SURVEYED BY: | APPROVED BY: S.H. |
| SCALE: | PROJ. No. | DWG. No. |
| HORIZONTAL: 1:500 | 12122 | 5 of 7 |
| VERTICAL: 1:100 | | |

CROSS SECTION 3
SCALE HOR 1:250 VER 1:50

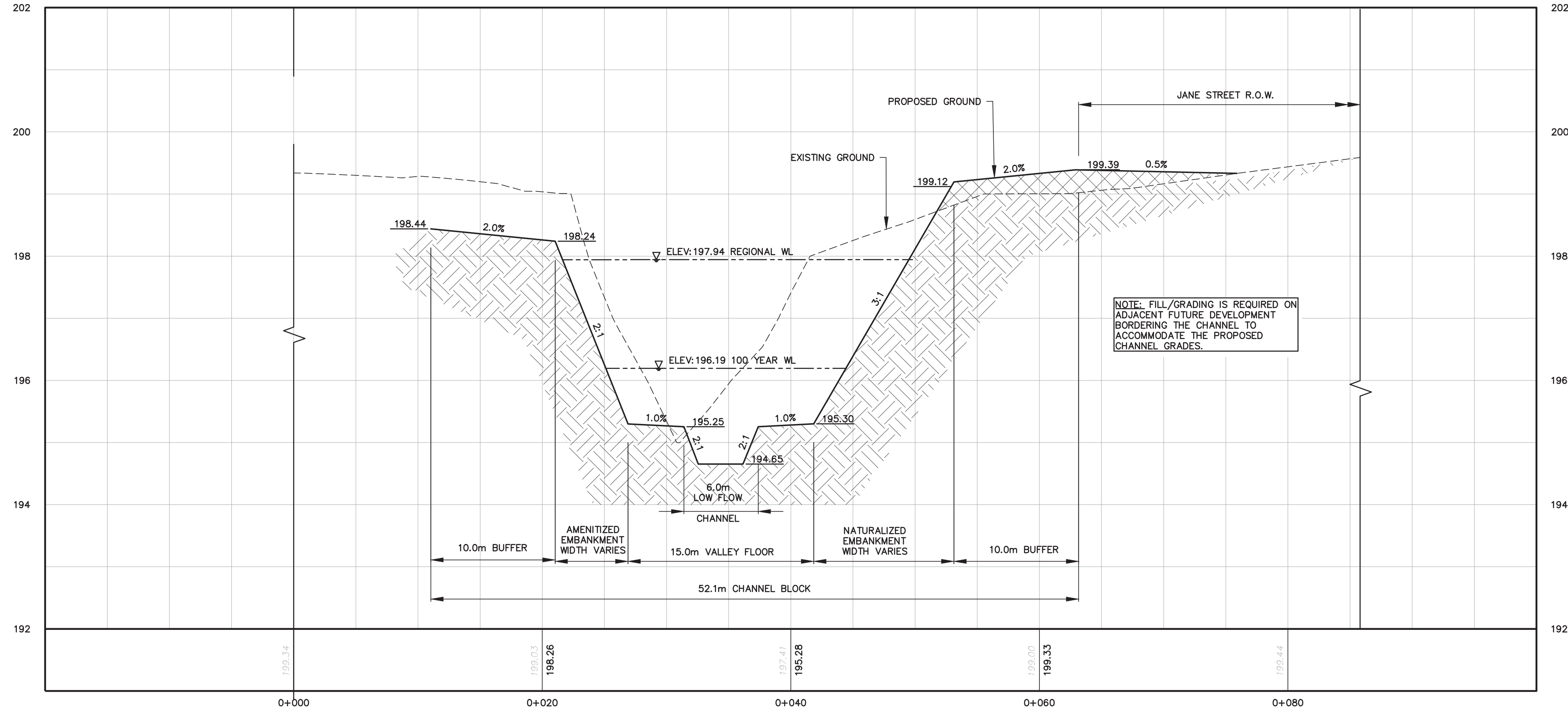

CROSS SECTION 4
SCALE HOR 1:250 VER 1:50

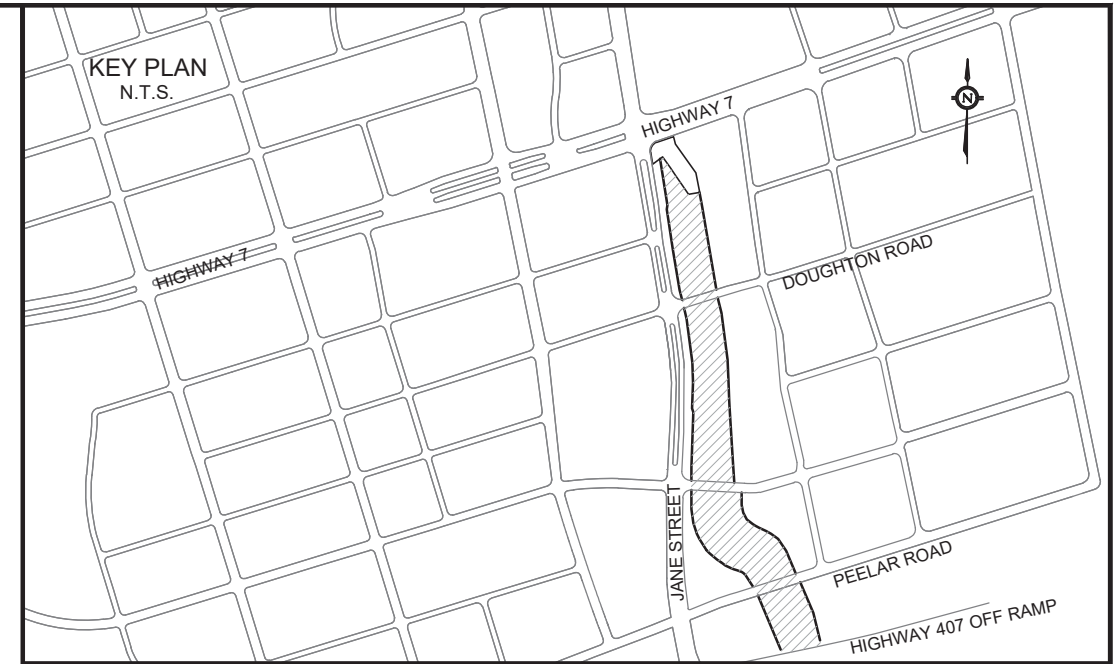
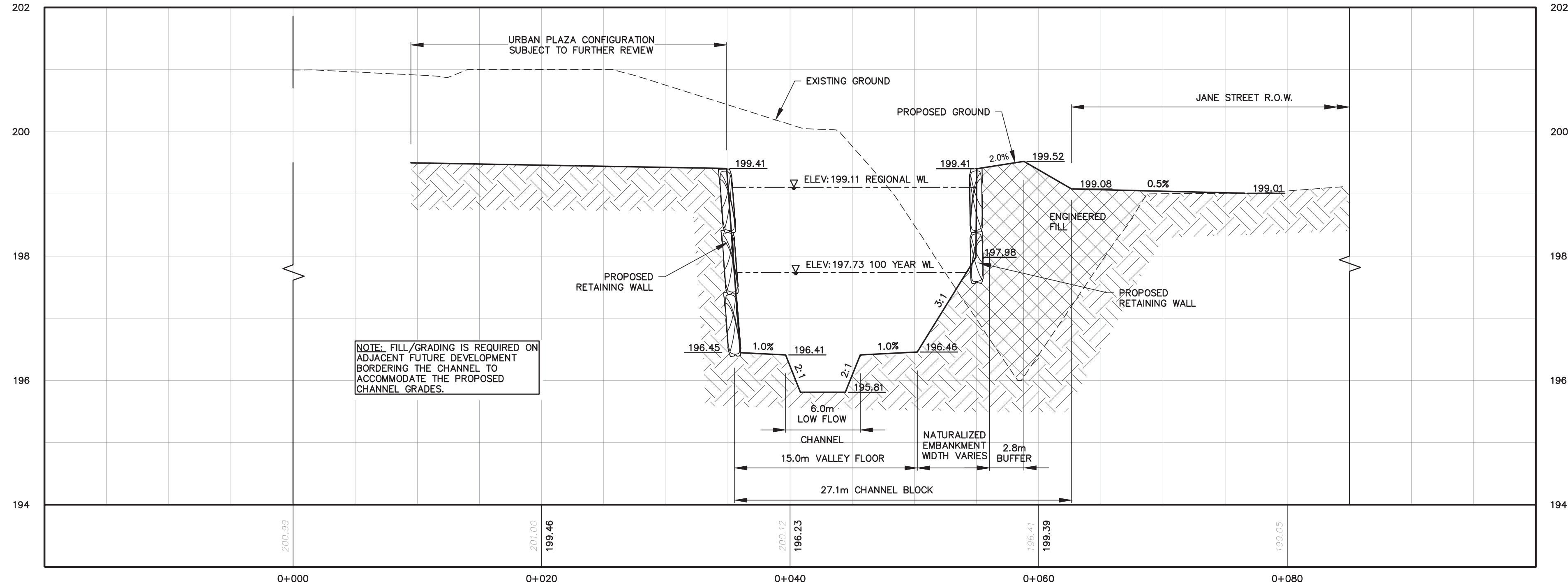

CONTRACTOR'S NOTES:

1. ALL DIMENSIONS ARE IN METRES UNLESS OTHERWISE INDICATED.
2. DRAWINGS ARE NOT TO BE SCALED FOR CONSTRUCTION.
3. THE CONTRACTOR SHALL VERIFY ALL DIMENSIONS IN THE FIELD AND SHALL REPORT ANY DISCREPANCIES TO THE ENGINEER IMMEDIATELY UPON FINDING.
4. THE EXACT LOCATION OF UTILITIES SHALL BE DETERMINED BY CONSULTING THE UTILITY COMPANIES CONCERNED. THE CONTRACTOR SHALL PROTECT THE LOCATION OF UTILITIES AND SHALL BE RESPONSIBLE FOR ADEQUATE PROTECTION FROM DAMAGE.
5. BENCHMARKS FOR LAYOUT ARE TO BE OBTAINED FROM THE CITY OF VAUGHAN ENGINEERING DEPARTMENT.

NOTE: EVERY REASONABLE EFFORT HAS BEEN MADE TO ENSURE THAT THE INFORMATION APPEARING ON THIS PLAN IS ACCURATE AND CURRENT. WE BELIEVE THE INFORMATION TO BE RELIABLE, HOWEVER, THE CITY OF VAUGHAN ASSUMES NO RESPONSIBILITY OF LIABILITY DUE TO ERRORS OR OMISSIONS.

BENCH MARK:
BENCHMARK IS LOCATED AT: _____

ELEVATION:

LEGEND

| | | | |
|-----|--------------------|-----------|------|
| 7 | | | |
| 6 | | | |
| 5 | | | |
| 4 | | | |
| 3 | | | |
| 2 | | | |
| 1 | PRELIMINARY DESIGN | T.D./E.T. | |
| NO. | DESCRIPTION | BY | DATE |

UPDATES & REVISIONS

| | | | |
|---|--|--|--|
| 7 | | | |
| 6 | | | |
| 5 | | | |
| 4 | | | |
| 3 | | | |
| 2 | | | |
| 1 | | | |

NOTE: FOR CROSS SECTION LOCATION REFER TO CHANNEL DRAWINGS 1 TO 4



ENGINEER'S STAMP:

APPROVED AS TO FORM IN RELIANCE UPON THE PROFESSIONAL SKILL AND ABILITY OF THE CONSULTING ENGINEERS AS TO DESIGN AND SPECIFICATIONS.

JACK GRAZIOSI, P.Eng., M.Eng.
DIRECTOR OF ENGINEERING SERVICES

DATE _____

VAUGHAN VMC BLACK CREEK
RENEWAL CLASS EA
PRELIMINARY CHANNEL DESIGN
TYPICAL SECTIONS 2 OF 2



| | | |
|--|--------------------|--------------------|
| DESIGNED BY: T.D. | DATE: AUGUST 2018 | CHECKED BY: E.T. |
| DRAWN BY: M.M. | SURVEYED BY: | APPROVED BY: S.H. |
| SCALE: HORIZONTAL: 1:500 VERTICAL: 1:100 | PROJ. No. 12122 | DWG. No. 6 of 7 |

FUTURE PEELAR ROAD
MID-SECTION DETAIL

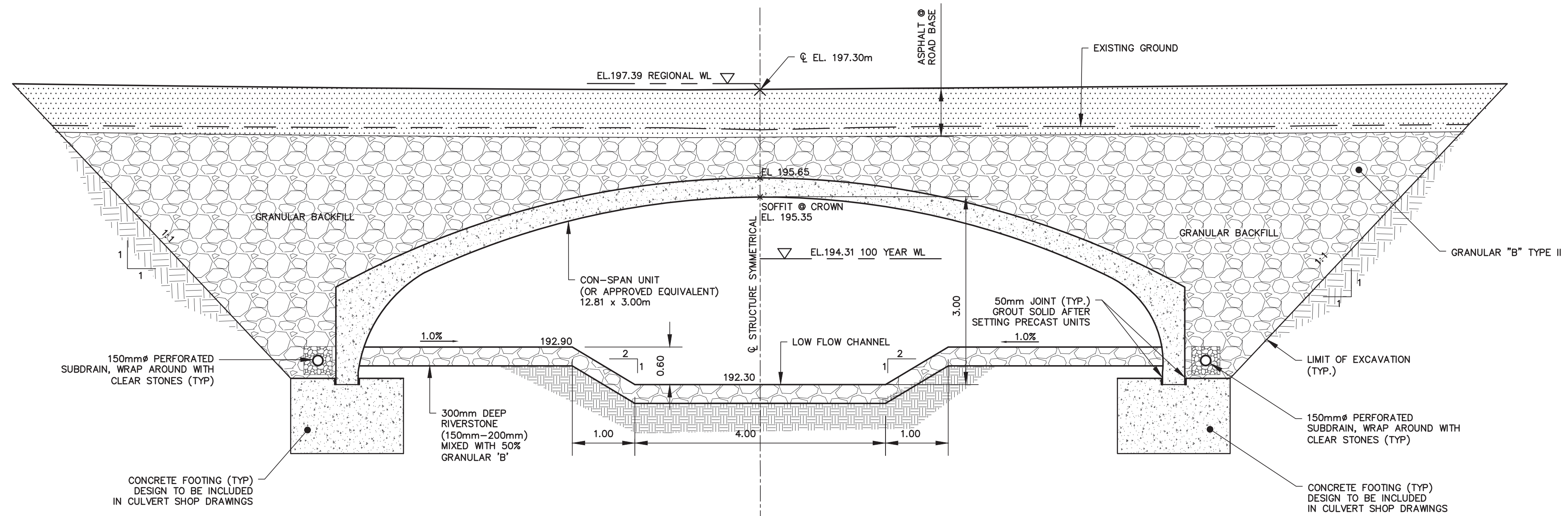

FUTURE INTERCHANGE WAY
MID-SECTION DETAIL

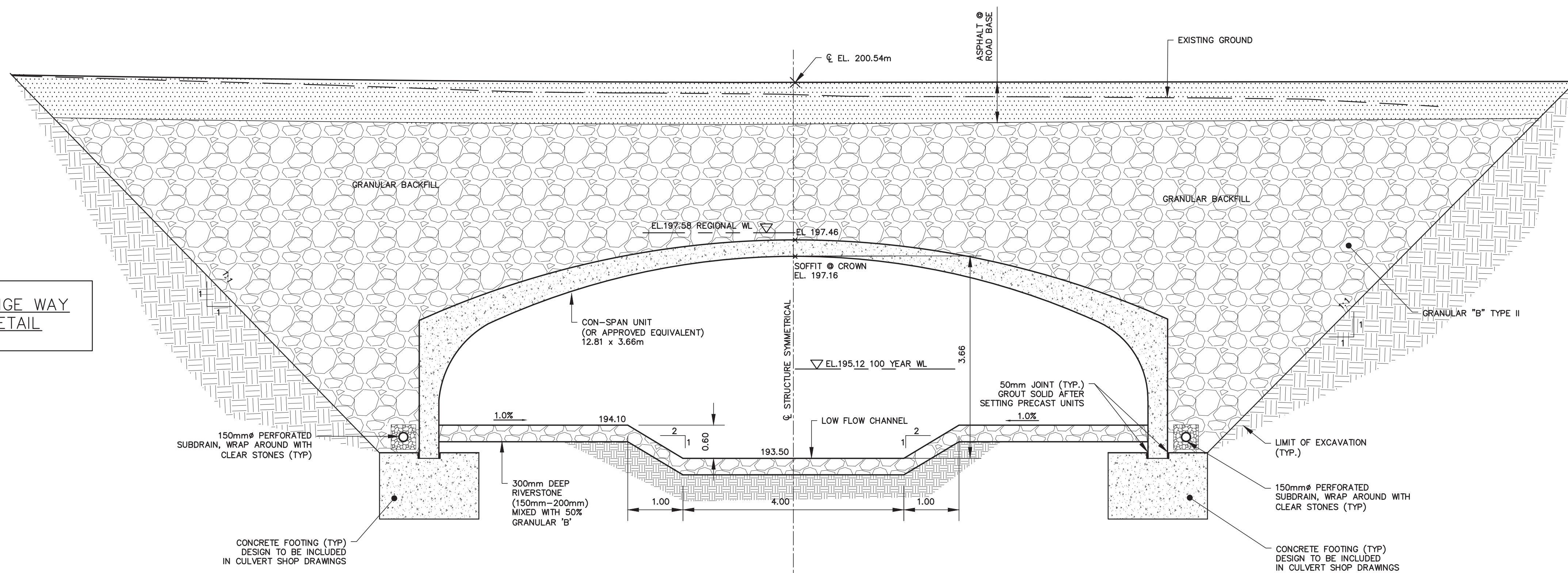

FUTURE DOUGHTON ROAD
MID-SECTION DETAIL

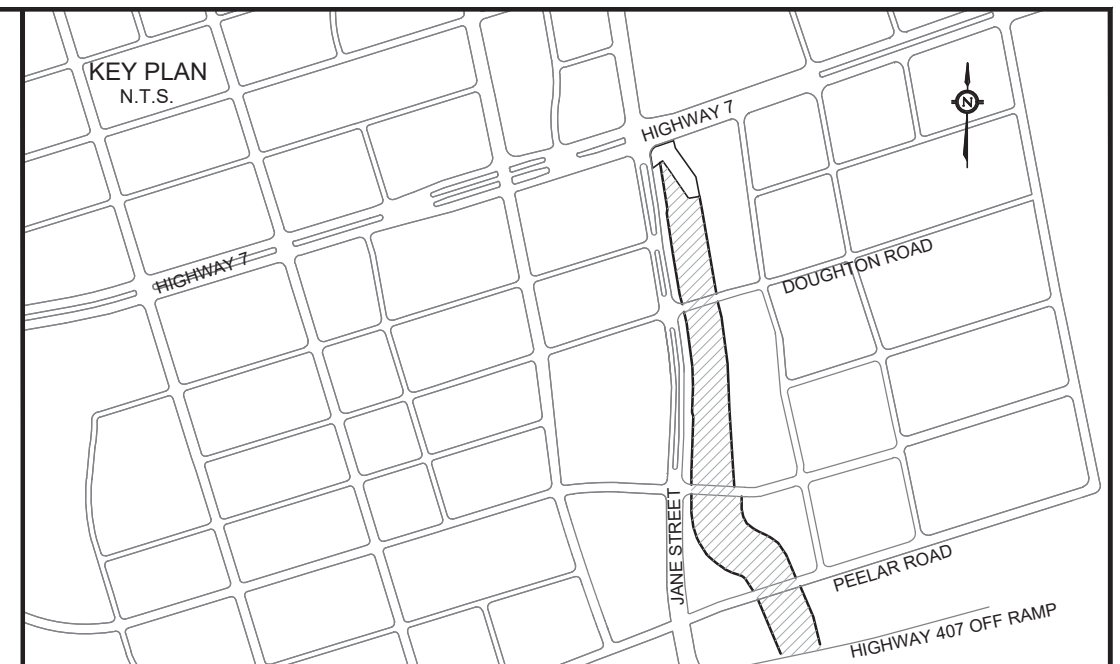
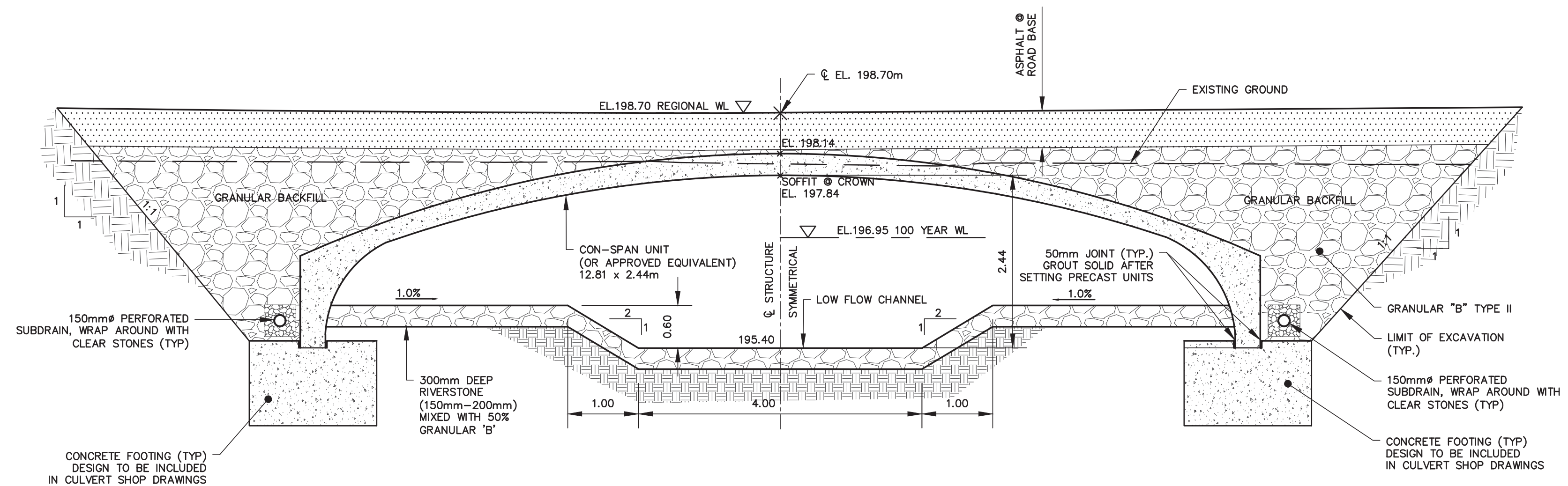

- CONTRACTOR'S NOTES:
1. ALL DIMENSIONS ARE IN METRES UNLESS OTHERWISE INDICATED.
 2. DRAWINGS ARE NOT TO BE SCALED FOR CONSTRUCTION.
 3. THE CONTRACTOR SHALL VERIFY ALL DIMENSIONS IN THE FIELD AND SHALL REPORT ANY DISCREPANCIES TO THE ENGINEER IMMEDIATELY UPON FINDING.
 4. THE EXACT LOCATION OF UTILITIES SHALL BE DETERMINED BY CONSULTING THE UTILITY COMPANIES CONCERNED. THE CONTRACTOR SHALL PROTECT THE LOCATION OF UTILITIES AND SHALL BE RESPONSIBLE FOR ADEQUATE PROTECTION FROM DAMAGE.
 5. BENCHMARKS FOR LAYOUT ARE TO BE OBTAINED FROM THE CITY OF VAUGHAN ENGINEERING DEPARTMENT.

NOTE:
EVERY REASONABLE EFFORT HAS BEEN MADE TO ENSURE THAT THE INFORMATION APPEARING ON THIS PLAN IS ACCURATE AND CURRENT. WE BELIEVE THE INFORMATION TO BE RELIABLE, HOWEVER, THE CITY OF VAUGHAN ASSUMES NO RESPONSIBILITY OF LIABILITY DUE TO ERRORS OR OMISSIONS.

BENCHMARK:
BENCHMARK IS LOCATED:

ELEVATION:

LEGEND

| | | | |
|---------------------|--------------------|---------|------|
| 7 | | | |
| 6 | | | |
| 5 | | | |
| 4 | | | |
| 3 | | | |
| 2 | | | |
| 1 | | | |
| NO. | DESCRIPTION | BY | DATE |
| | PRELIMINARY DESIGN | T.D/E.T | |
| UPDATES & REVISIONS | | | |

TMIG
The Municipal Infrastructure Group Ltd

8800 Dufferin Street,
Suite 200
Vaughan, ON
L4K 0C5
p: 905.738.5700
f: 905.738.0065

ENGINEER'S STAMP:
APPROVED AS TO FORM IN RELIANCE UPON THE PROFESSIONAL SKILL AND ABILITY OF THE CONSULTING ENGINEERS AS TO DESIGN AND SPECIFICATIONS.

JACK GRAZIOSI, P.Eng., M.Eng.
DIRECTOR OF ENGINEERING SERVICES

DATE

VAUGHAN VMC BLACK CREEK
RENEWAL CLASS EA
PRELIMINARY CHANNEL DESIGN
CULVERT SECTION DETAILS



| | | |
|-------------------|-------------------|-------------------|
| DESIGNED BY: T.D | DATE: AUGUST 2018 | CHECKED BY: E.T. |
| DRAWN BY: M.M. | SURVEYED BY: | APPROVED BY: S.H. |
| SCALE: | PROJ. No. | DWG. No. |
| HORIZONTAL: 1:500 | 12122 | 7 of 7 |
| VERTICAL: 1:100 | | |